



S U S S E X

Tapware is to be installed by a Licensed Plumber in accordance with AS/NZS 3500:2003

Recommended working water pressure 300-500 kpa.
Maximum water temperature is 65 deg.c.

Circa

INSTALLATION GUIDE

Circa Wall Basin/Bath Mixer System RH
Dress Kit

Product Code CIR-08

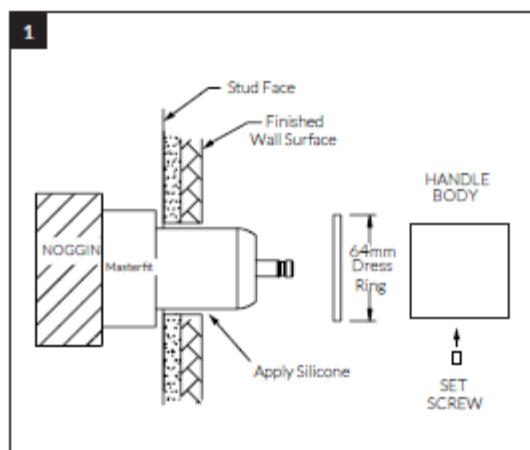

MIXER DRESS KIT

- Remove Mixer protective cover.
- Using silicone, seal the wall surface around the Mixer and Outlet threads.
- Fit the Mixer Dress Ring.
- Fit the Handle Body onto the Mixer Cartridge Lever and ensure full engagement.
- Secure the Handle Body by tightening the Set screw using the Allen Key provided (tighten well).

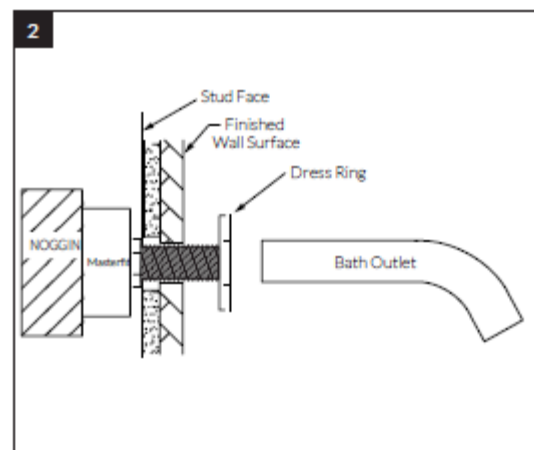

OUTLET FIT OFF

- Apply sealing tape (Teflon) to male thread.
- Place Dress Ring and Dress Flange over prepared male thread.
- Fit and align the Outlet.
- To complete installation, operate the Mixer(s) checking the flow of both hot and cold water from the Outlet. Check all fittings and fixtures for water leaks.

ACS

1300 898 889

www.acsbathrooms.com.au